

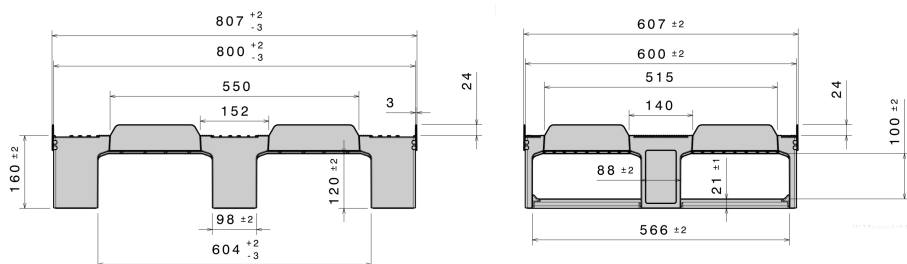



D2 ESD

800 x 600 mm



Art. no. 83510228

Technical data

| | |
|---------------------------|--|
| Dimensions L x W x H (mm) | 800 x 600 x 160 |
| Weight (kg) | 8.5 |
| Material* ² | PP, Leitfähig |
| Load capacity (kg) | <div>  Static 2000 kg </div> |

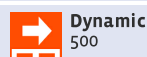

Dynamic
500



In Racking System

Characteristics

Colour: black
Runners: 3, unwelded
Rims: 24 mm outside
Temperature stability: -30 °C to +40 °C, briefly up to +90 °C
Conductive pallet
Surface resistance of $\geq 1 \times 10^4$ Ohm to $< 1 \times 10^{11}$ Ohm

Options

Antislip
Rim options

Loading quantities (Pcs / Approximate amount)

| | | |
|---|--|--|
|  Container | Container 20': 384 Container 40': 780 | Container 40' High Cube: 880 Conventional trailer 45' high cube container: 1020 |
|  Truck | MEGA-Trailer: 1224 | Jumbo: 1368 |

Labelling

Customised printing and numbering available on request depending on quantity. Position upon consultation.



*¹ All technical data include characteristic features, which have been tested under specially defined conditions. Varying data may result from different conditions of usage such as loading method, prevailing temperature and length of storage time. All data and specified information are subject to change without notice. Our service team is pleased to be at your disposal to check the special requirements of your individual application.

*² Our service team is pleased to be at your disposal if you require exact information about material compositions.

*³ **Static load:** resistance to pressure on a flat ground surface and an evenly distributed load at a room temperature of approx. 20 °C.
Dynamic load: on a forklift with an evenly distributed load at a room temperature of approx. 20 °C.
In racking system: evenly distributed load (sacks) along the longitudinal sides. Resting on two supports for over 100 h at a room temperature of approx. 20 °C.